

# RETAIL REALTY SERVICES

*Full Service Real Estate & Construction Management Company*



## PROPERTY HIGHLIGHTS

**Address:** 10519 20th Street SE  
Everett, Washington, 98205

**Price:** \$ 17.50 S/F Rent

**NNN:** \$ 5.00 S/F

**Suite:** 887 S/F

**Furniture:** available office furnishings

**Available Immediately**

**Inside End Cap**

**On site parking**

## PROPERTY DESCRIPTION- South Lake Campus

Office space is available in the South Lake Campus in Lake Stevens WA. Suite has two enclosed offices and 3 cubicles set up, office furniture is available for tenant if needed. Small file room, storage and bathroom at rear of space. Prior tenant was an insurance brokerage, office rental is preferred but will look at retail with the right tenant. Road pylon signage is available on 20th and South Lake Stevens Road. Other tenants in the retail strip are medical use, Teryaki, pizza and tanning.



**CHAD A. GLEASON**

9831 S. 220th Place, Kent, WA 98031 tel: 253.656.5357 fax: 253.559.7956

e-mail: [chad@retailrs.com](mailto:chad@retailrs.com) website: [www.retailrs.com](http://www.retailrs.com)

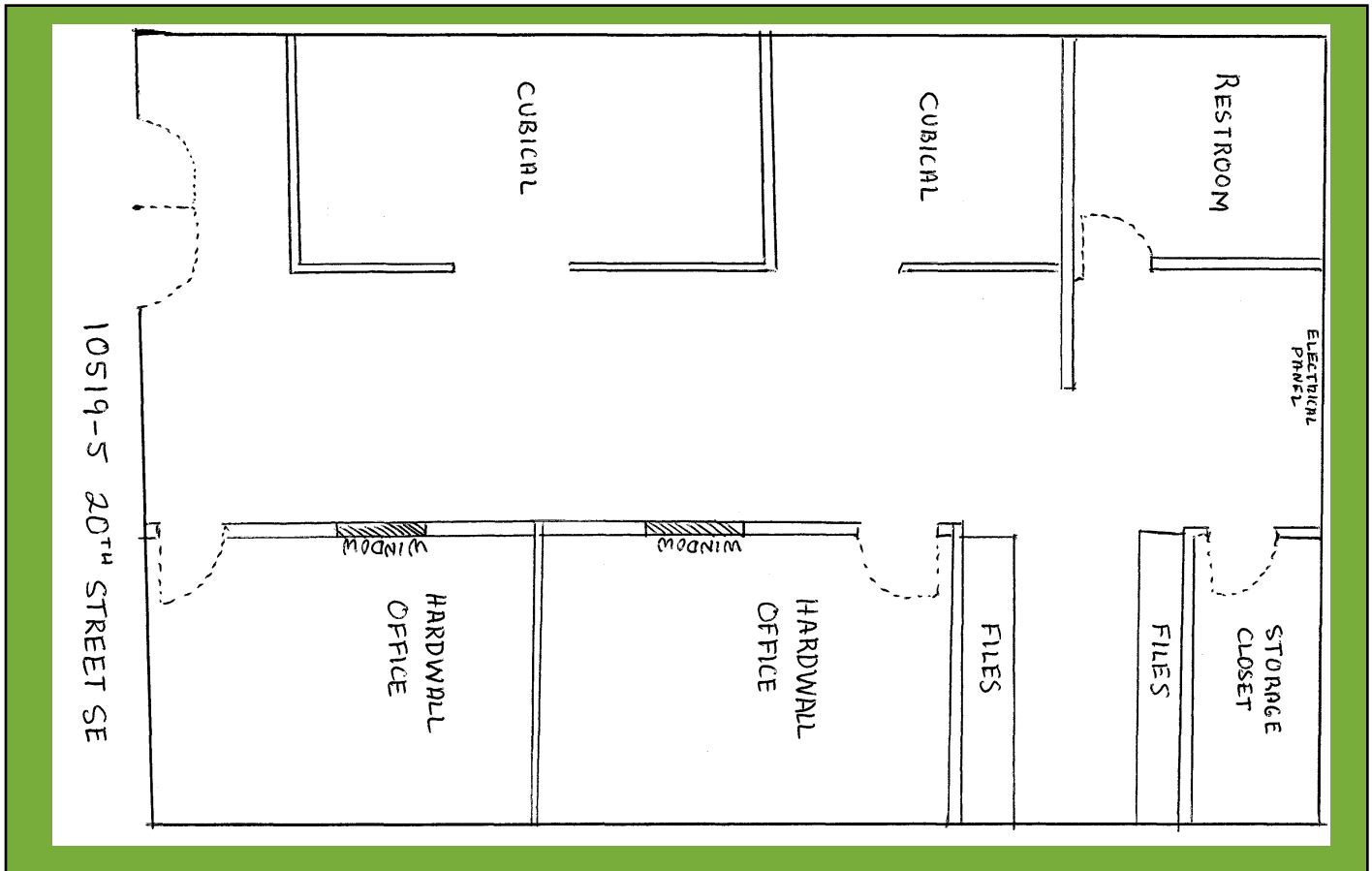

## Demographics

### 5 Minute drive times

Populations: 12865  
 Avg. HI: \$37,697.00  
 HH: 3,019  
 Business: 238

### 10 Minute drive times

Populations: 59,959  
 Avg. HI: \$49,051  
 HH: 22,295  
 Business: 3,267

Full demographics package on request.